

# dry.power

## Valve regulated lead-acid batteries



Motive Power Systems

**Reserve Power Systems**

Special Power Systems

Service

### Your benefits with HOPPECKE dry.power

- **Maintenance-free regarding water refilling** - due to Absorbent Glass Mat-technology
- **Very good high-current capability** - low investment costs due to innovative electrode structure
- **Very good space utilization** - due to maximum energy density

### Typical applications of HOPPECKE dry.power

- **Uninterruptible power supply (UPS)**
- **Telecommunications**  
Mobile phone stations,  
BTS-stations, off-grid/on-grid  
solutions
- **Security lighting**



## Type overview

### Capacities, dimensions and weights

Type	C <sub>20</sub> /1.75 V Ah	C <sub>1/2</sub> /1.75 V Ah	C <sub>1/4</sub> /1.70 V Ah	C <sub>1/6</sub> /1.60 V Ah	Weight kg	Terminal Type	Length L mm	Width W mm	Height H mm
dry.power 12 V 7 Ah	7	4	3	3	2.9	A	151	65	100
dry.power 12 V 12 Ah	12	6	6	4	4.1	A	151	98	101
dry.power 12 V 18 Ah	18	10	8	6	6.1	B	181	77	167
dry.power 12 V 25 Ah	25	14	12	9	8.8	B	166	175	125
dry.power 12 V 33 Ah	33	18	16	15	11.0	C	195	130	168
dry.power 12 V 40 Ah	40	21	18	17	13.5	B	197	165	170

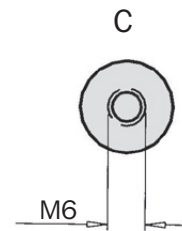
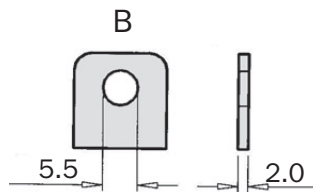
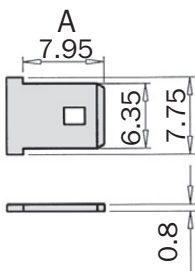

dry.power 12 V 18 Ah  
dry.power 12 V 25 Ah  
dry.power 12 V 33 Ah  
dry.power 12 V 40 Ah

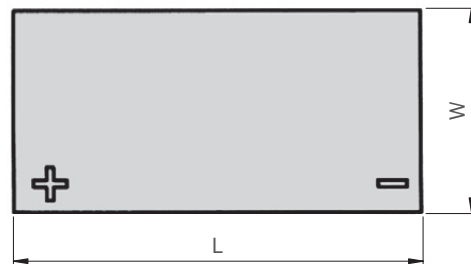

dry.power 12 V 7 Ah  
dry.power 12 V 12 Ah

Design life: 3-5 years (according to EUROBAT)

**Optimal environmental compatibility - closed loop for recovery of materials in an accredited recycling system**